



1.1

1.2

1.3

1.4

## Function

2.1

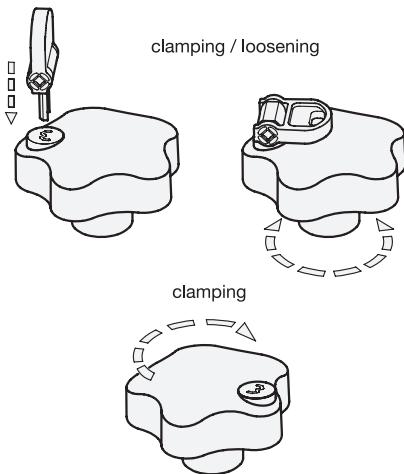

**With** key in the lock (no rotation required) the regular function of the star knob (clamping / loosening) is given.

2.2

**Without** key in the lock the star knob can only be clamped - only clockwise rotation. At anti-clockwise rotation (loosening) the indexing mechanism disrupts the knob from the threaded bushing.

2.3

2.4

